

SYDNEY COVE

PROPERTY



803A/148 Elizabeth St Sydney NSW



This beautifully presented, recently refreshed apartment features a massive floorplan with an abundance of internal space and a well sized balcony. Situated in an unbeatable location, you are moments away from Hyde Park, World Square shopping centre, and only a short stroll to Museum Station. The perfect entry level apartment for owner occupiers and a fantastic option for astute investors.

- Large 60sqm floorplan including a west facing balcony
- Spacious living & dinning room, separate bedroom area
- Freshly refurbished with new carpet, paint, lighting and blinds
- Two built in fold down beds designed to maximise living space
- Gas kitchen with ample storage, separate laundry room
- Pool, spa, sauna, steam room, gym, 24hr concierge, onsite building manager

Price : \$ 600,000
Building Size : 60 sqm
View : <https://www.sydneycoveproperty.com/sale/nsw/sydney-city/sydney/residential/studio/7922354>



Brenden Taliana
02 9241 1288



Bryn Fowler
02 8259 3333

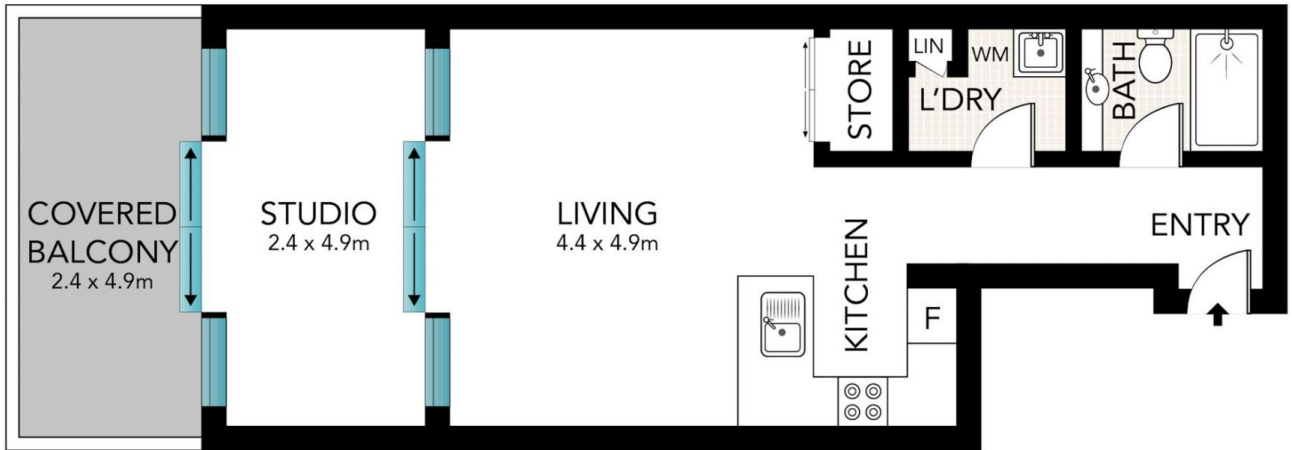

Scale in metres. Indicative only. Dimensions are approximate. All information contained here in is gathered from sources we believe to be reliable. However, we cannot guarantee its accuracy and interested persons should rely on their own enquiries.

803A/148 Elizabeth Street, Sydney

**SYDNEY
COVE**
PROPERTY