

SYDNEY COVE

PROPERTY



1009/38 Bridge Street Sydney NSW

1 1

Located in the contemporary Bridgeport building near Circular Quay, this modern fully furnished one bedroom apartment provides an exceptional city pad or investment opportunity in an in-demand locale. Boasting tranquil views over tree-lined Macquarie Place Park, and plenty of natural light this apartment is definitely one to inspect. Rental expectations of \$800 per week.

Price : \$ 700,000
Building Size : 37 sqm
View : <https://www.sydneycoveproperty.com/sale/nsw/sydney-city/sydney/residential/apartment/7917793>

*Well presented, fully furnished, apartment on level 10 with park view

*In the popular 'Bridgeport' building, located only 300 metres away from Sydney Harbour

*Bridgeport benefits hugely from its position near the exciting new Quay Quarter neighbourhood

*Surrounded by cafes, restaurants, bars and a short walk to Trams and Circular Station

*Easy walk to harbour, Opera House, Bridge St light rail,



Bryn Fowler
02 8259 3333



Grant Ashby
02 9241 1288

<https://www.sydneycoveproperty.com>

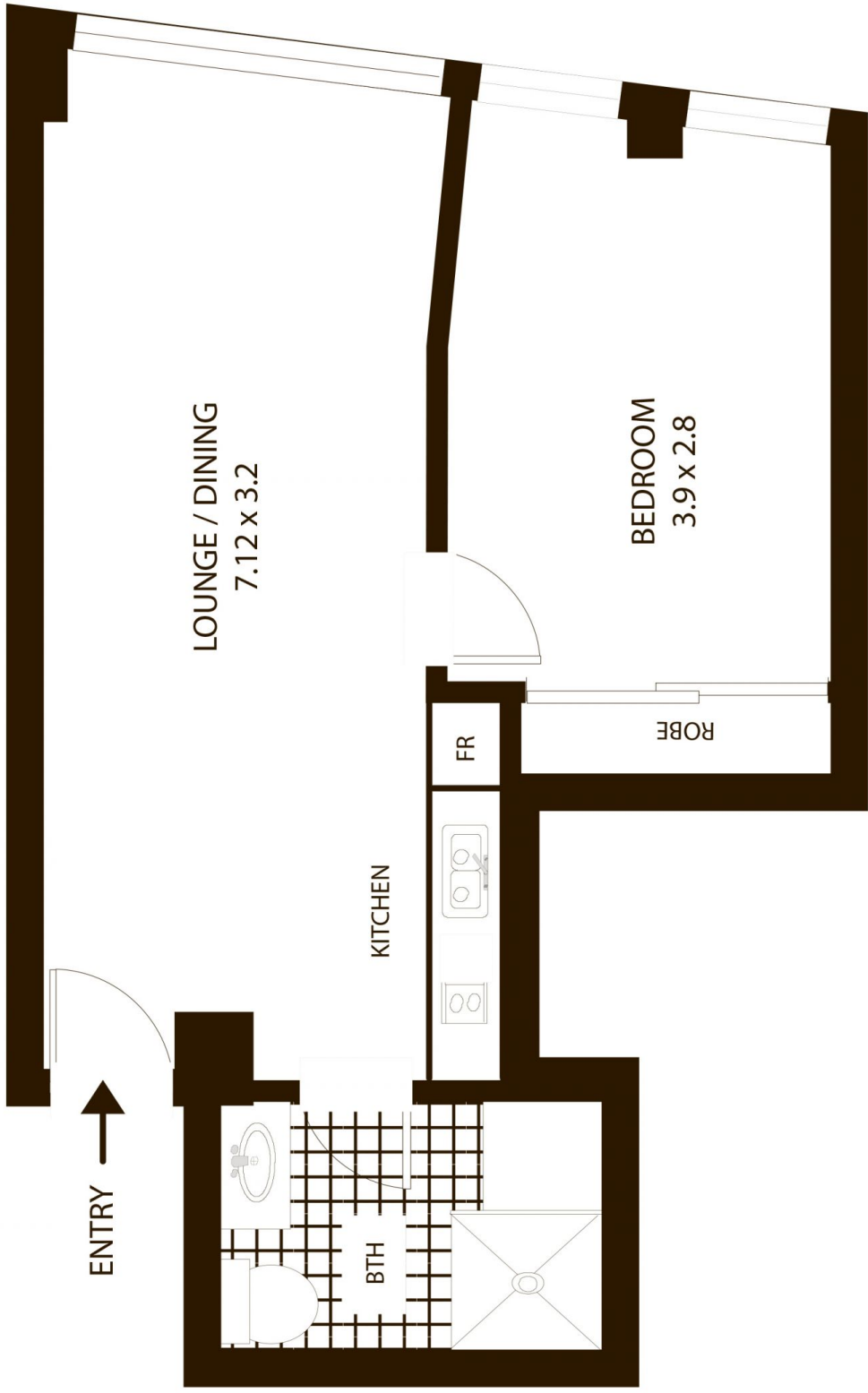

1009/38 Bridge St Sydney

All measurements are approximate only. Plan is provided as an indication of layout

