

# SYDNEY COVE

PROPERTY



**424/303 Castlereagh Street Sydney NSW**

2 🛏 2 🚿 2 🚗

Positioned above the city bustle on the 34th floor of the renowned 'Regis Tower' is the sub-penthouse apartment you've been waiting for.

From the moment you step into your new sub-penthouse on floor 34 the view will capture you. With a highly desired easterly aspect, the 122sqm of indoor and outdoor space is your private oasis. The enormous outdoor deck captures just the right amount of breeze to make those early evening drinks overlooking the city divine. The new designer kitchen with gas cook top, quality appliances and abundant storage will make entertaining a pleasure.

The Master Suite features a private oversized ensuite that has incredible views of the city and a fabulous spa bath perfect for relaxing. With its' own independent access to the large outdoor deck, the Master Suite is a sanctuary.

**Price** : \$ 1,275,000  
**Building Size** : 122 sqm  
**View** : <https://www.sydneycoveproperty.com/sale/nsw/sydney-city/sydney/residential/apartment/7734288>



**Brenden Taliana**  
02 9241 1288



**Grant Ashby**  
02 9241 1288

<https://www.sydneycoveproperty.com>

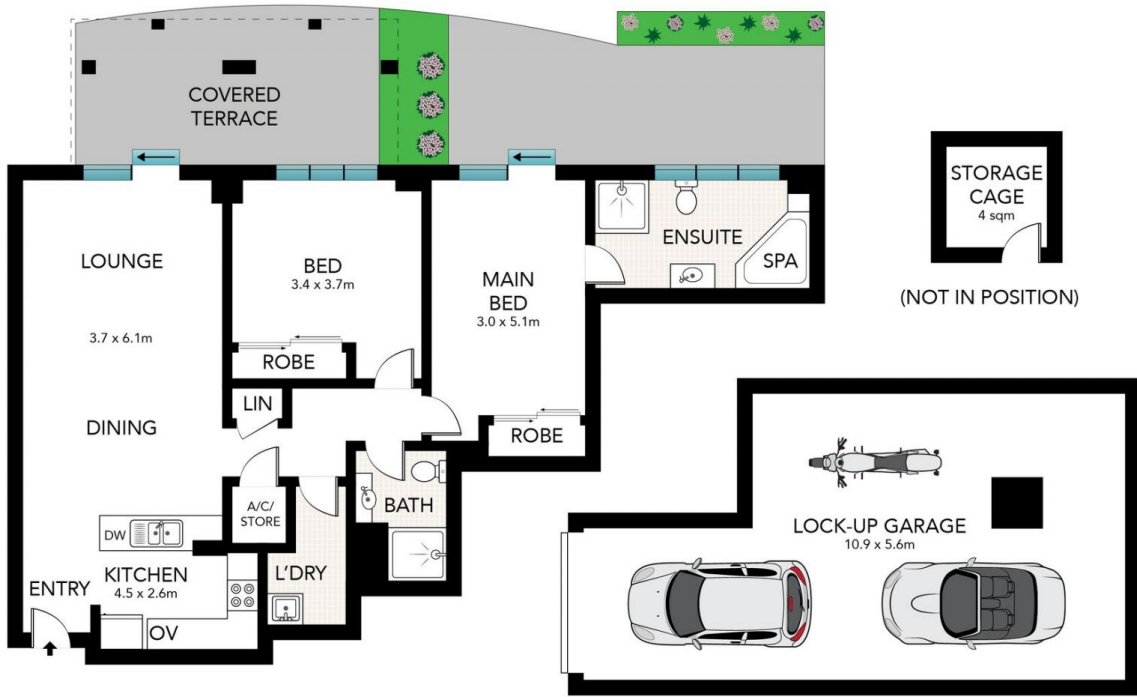

(NOT IN POSITION)

Internal: 122 sqm  
 Garage: 50 sqm  
 Storage: 4 sqm



Scale in metres. Indicative only. Dimensions are approximate. All information contained here in is gathered from sources we believe to be reliable. However, we cannot guarantee its accuracy and interested persons should rely on their own enquiries.

424/303 Castlereagh Street, Haymarket

**SYDNEY  
 COVE**  
 PROPERTY