

# SYDNEY COVE

PROPERTY



## 27 King Street SYDNEY NSW

1 1

Experience the vibrancy of a mid-city lifestyle within footsteps of world class dining and retail precincts. 47 sqm one bedroom apartment set within the Kingsleigh a well-established boutique security complex ideally positioned on the cusp of Darling Harbour and Barangaroo.

**Building Size** : 47 sqm  
**View** : <https://www.sydneycoveproperty.com/lease/nsw/sydney-city/sydney/residential/apartment/7339151>

### Key Points:

- Split A/C to living, double glazed windows
- Stone kitchen bench tops, breakfast bench
- Bespoke joinery, floating floors throughout
- Gas cooktop, full size dishwasher and oven
- Moments to Barangaroo & Darling Harbour
- Walk to world class dining & retail precincts
- Rooftop pool, Darling Harbour water views



**Cherie Xue**  
02 9241 1288



**Gareth Bootland**  
02 8259 3333

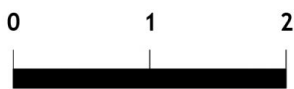
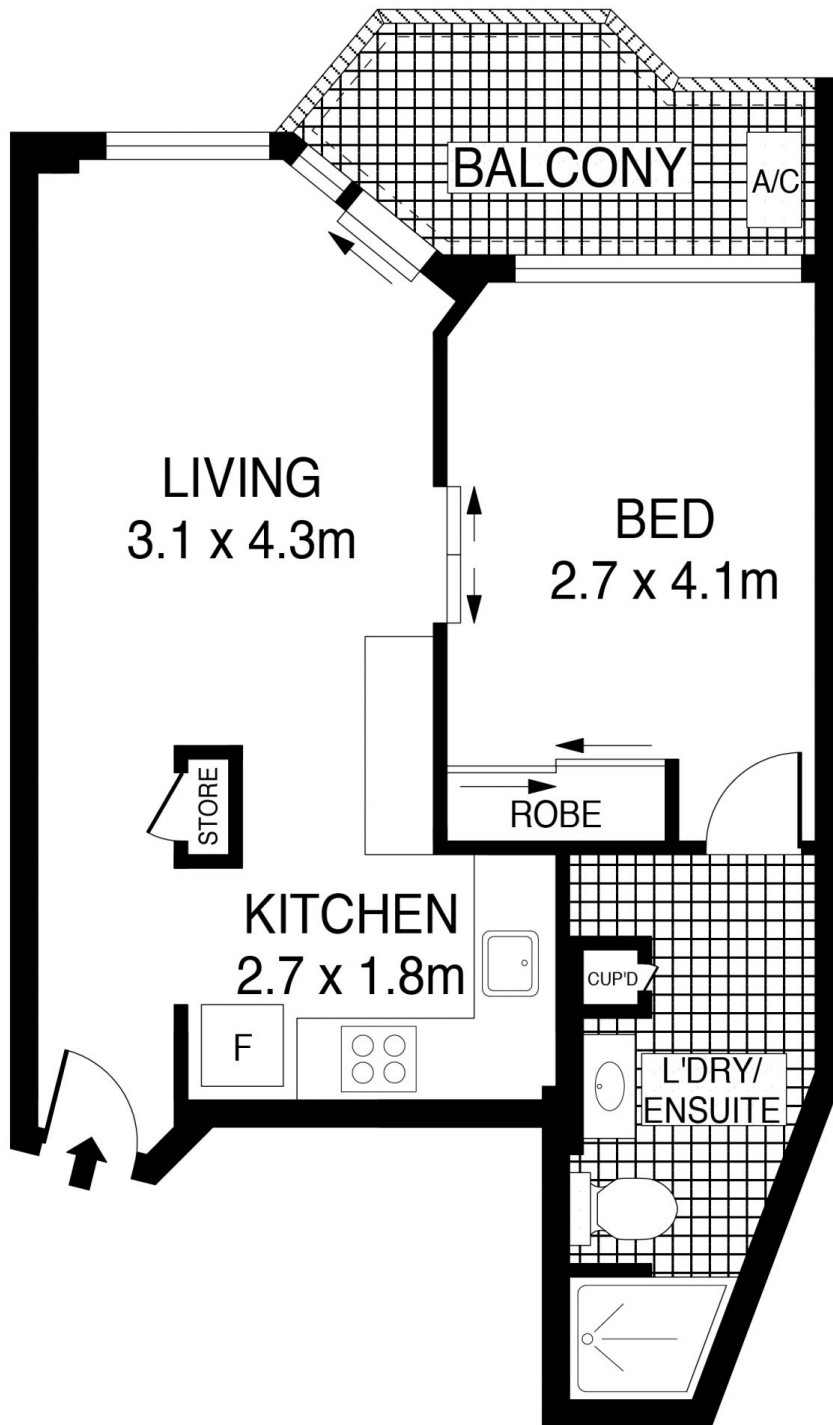

SCALE (METRES)

PLANS SHOWN ONLY INDICATIVE OF LAYOUT. DIMENSIONS ARE APPROXIMATE.  
Ref. No: 94779



403/27 KING STREET

SYDNEY