

# SYDNEY COVE

PROPERTY



## 906/1 Hosking Place SYDNEY NSW

1 1

Located in the ever popular The Aston Apartments - just off Martin Place, a great place to live and enjoy the conveniences and vibrancy of city life in a world class city. Well proportioned floorplan with good sized balcony and an open urban outlook towards Martin Place. With such a fantastic mid-city location, The Aston also provides savvy investors the assurance of strong rental demand in an ever-popular residence for professional tenants in Sydney's rapidly transforming CBD. The Aston is only 140 metres to Martin Place Train Station and surrounded by some of Sydney's best shopping and restaurants.

**Price** : \$ 720,000

**View** : <https://www.sydneycoveproperty.com/sale/nsw/sydney-city/sydney/residential/apartment/6215555>



**Bryn Fowler**  
02 8259 3333

? Well located 53m2 one bedroom apartment, open aspect to Martin Place

? Only metres to Martin Place Station in such a fantastic mid-city location

? Located on the 9th floor of the increasingly popular, The

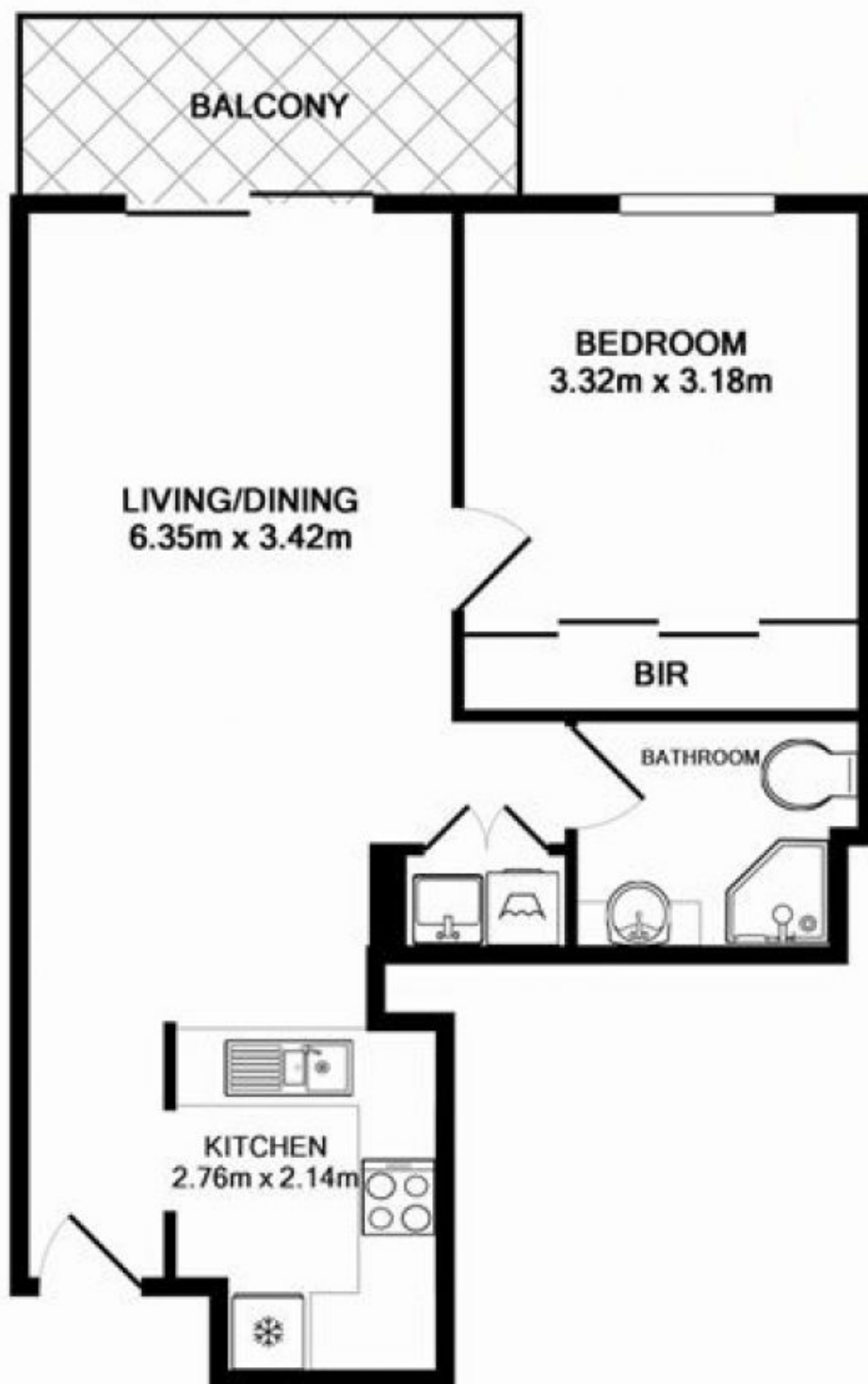

**TOTAL APPROX. FLOOR AREA 53.0 SQ.M.**  
Measurements are approximate. Not to Scale. For Illustrative purposes only.