

SYDNEY COVE

PROPERTY



129 Harrington Street SYDNEY NSW

2  2  1 

Offering one of the best floorplans in the multi award winning development 'Cove' this north facing two bedroom apartment offers commanding city & Harbour views from every room. Positioned in the heart of the rocks this architectural master piece is surrounded by fantastic shops and restaurants as well as being extremely close to stations, transport and the CBD.

Building Size : 109 sqm
View : <https://www.sydneycoveproperty.com/lease/nsw/sydney-city/sydney/residential/apartment/6215339>

Key points:

- * Two double bedrooms both with built in wardrobes
- * Impressive floor to ceiling windows to optimize view
- * Large north facing balcony, perfect for entertaining
- * Galley style kitchen with stainless steel appliances
- * Internal laundry, separate study area & ducted A/C
- * 24 hour concierge, pool, gym, sauna & steam room
- * Walking distance to CBD, transport and restaurants



Grant Ashby
02 9241 1288



Cherie Xue
02 9241 1288



NORTH

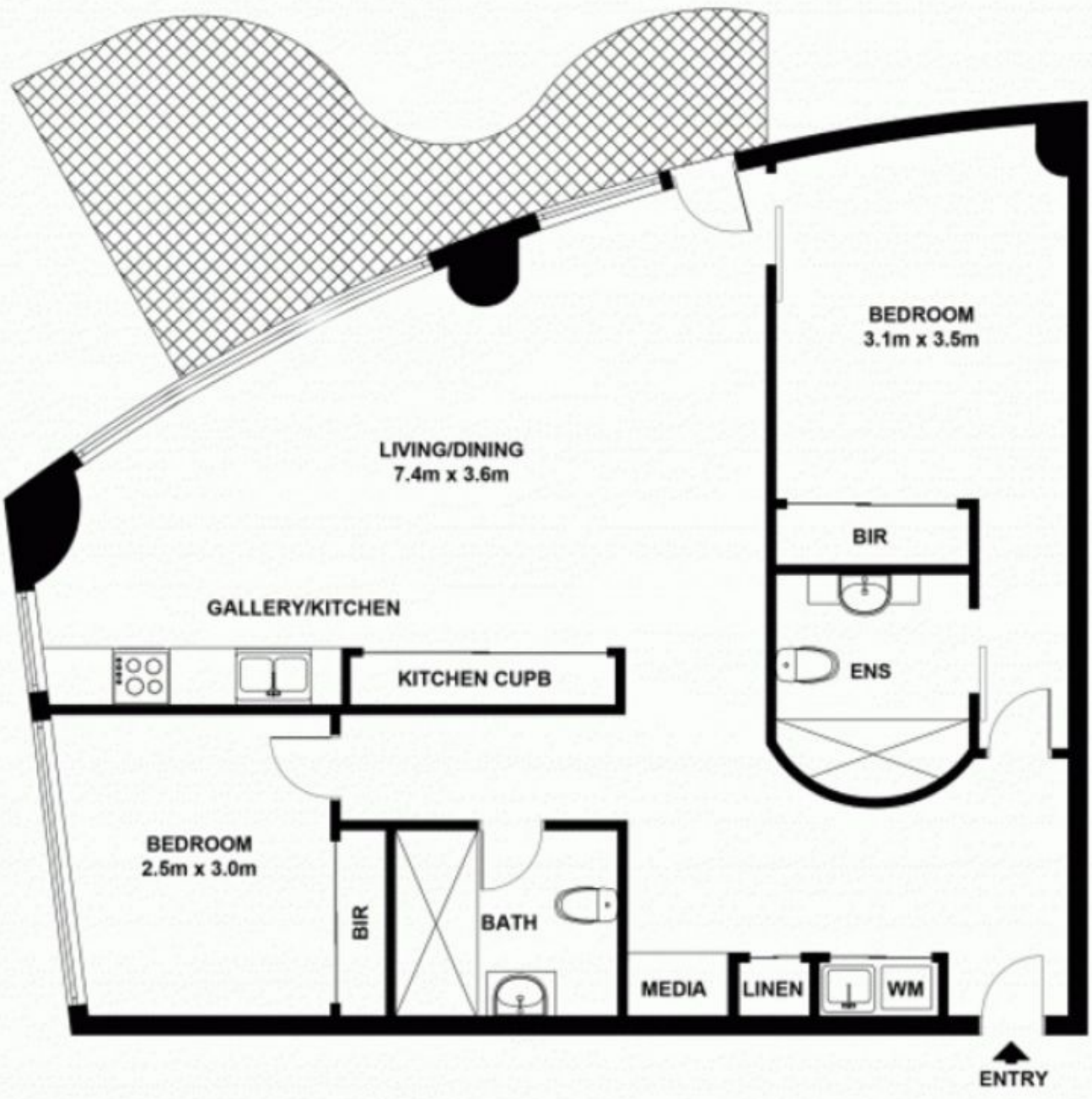

LIVING/DINING
7.4m x 3.6m

BEDROOM
3.1m x 3.5m

GALLERY/KITCHEN

KITCHEN CUPB

BIR

ENS

BEDROOM
2.5m x 3.0m

BIR

BATH

MEDIA

LINEN

WM

ENTRY