

# SYDNEY COVE

PROPERTY

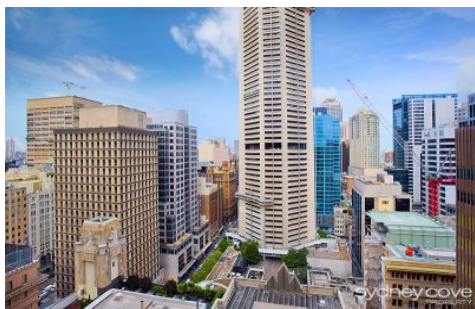

## 2703/1 Hosking Place SYDNEY NSW

1 1

A very rare offering, this immaculately presented apartment in The Aston features the most popular and largest floorplan in the building at 69m<sup>2</sup>, positioned high up on level 27. The apartment is well presented with two balconies, city views and would provide an ideal city base or quality investment in an a fantastic location just off Martin Place. Nestled between Pitt & Castlereagh Streets, moments to the best of everything Sydney has to offer, The Aston also features an outdoor pool, sundeck, spa, BBQ, gym and on -site Building Manager.

- Spacious, and well-proportioned interiors
- Two balconies with South & East city Views
- Positioned high up on level 27 of The Aston
- Living areas and bedroom are double-glazed
- Large gas kitchen with plenty of bench space
- Light & airy interiors and great floorplan

**View :** <https://www.sydneycoveproperty.com/sale/nsw/sydney-city/sydney/residential/apartment/6215217>



**Bryn Fowler**  
**02 8259 3333**

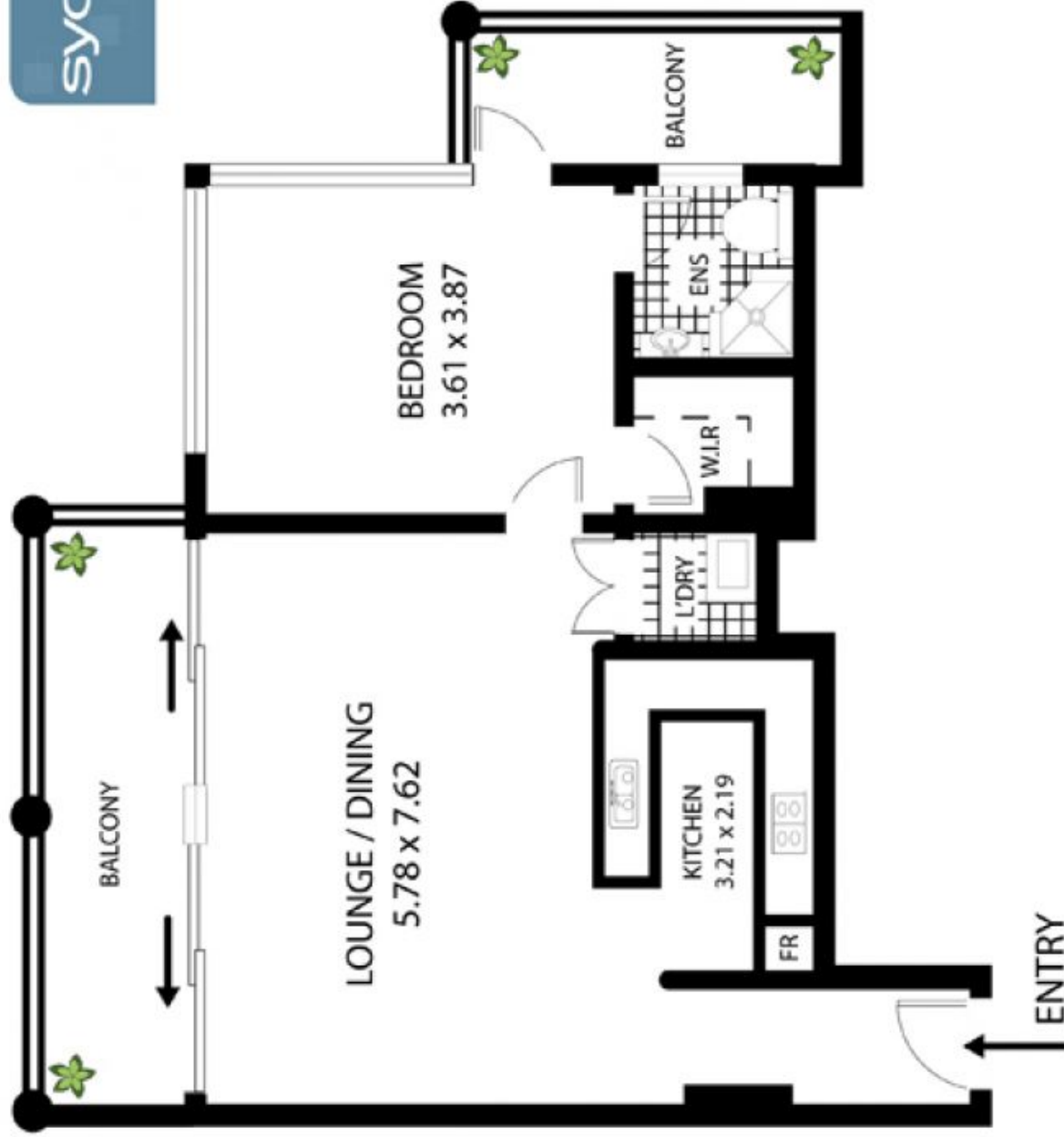

# 2703/1 Hosking Pl Sydney

All measurements are approximate only. Plan is provided as an indication of layout

