

SYDNEY COVE

PROPERTY



12/222 Sussex Street Sydney NSW

2  2  1 

SOLD BY BRYN FOWLER 0423 663 663

Well-presented 148m2 two bedroom apartment now available in highly sought-after and tightly held Astoria Tower. Ideally positioned within an easy walk to Darling Harbour, Cockle Bay restaurants and bars, QVB, and Town Hall. An ideal city residence to enjoy the best Sydney has to offer or solid investment choice in a high demand area.

- *Spacious light & airy living areas, two large balconies
- *Freshly painted and re-carpeted and ready to move in
- *Two generous double bedrooms with balcony access
- *Two modern bathrooms, master bedroom with ensuite
- *Large open gas kitchen, ample bench space, dishwasher
- *Rare security lock-up garage on title, 24 hour concierge
- *Well-equipped gym, pool, spa, sauna, squash court, games room

View : <https://www.sydneycoveproperty.com/sale/nsw/sydney-city/sydney/residential/apartment/6214984>



Bryn Fowler
02 8259 3333

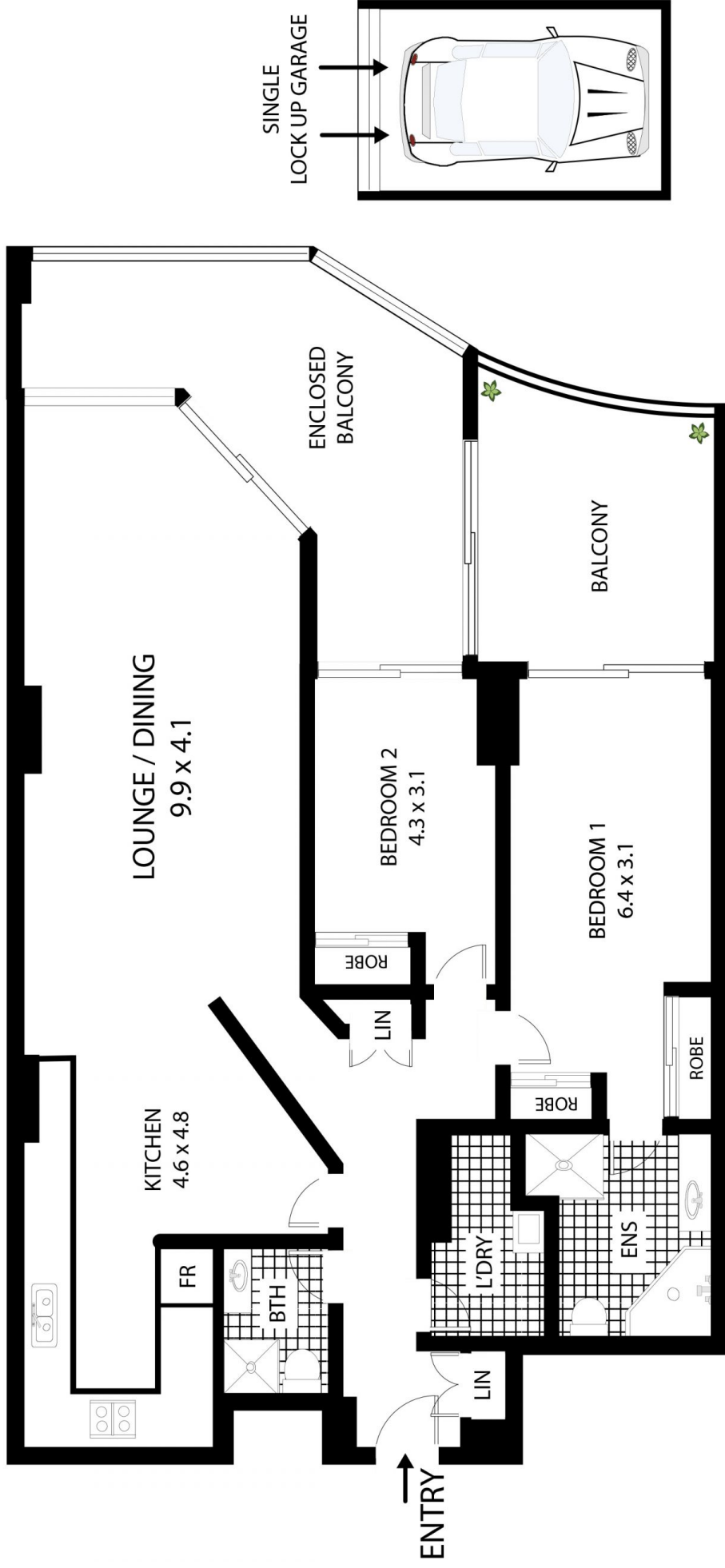

12/222 Sussex St Sydney

All measurements are approximate only. Plan is provided as an indication of layout



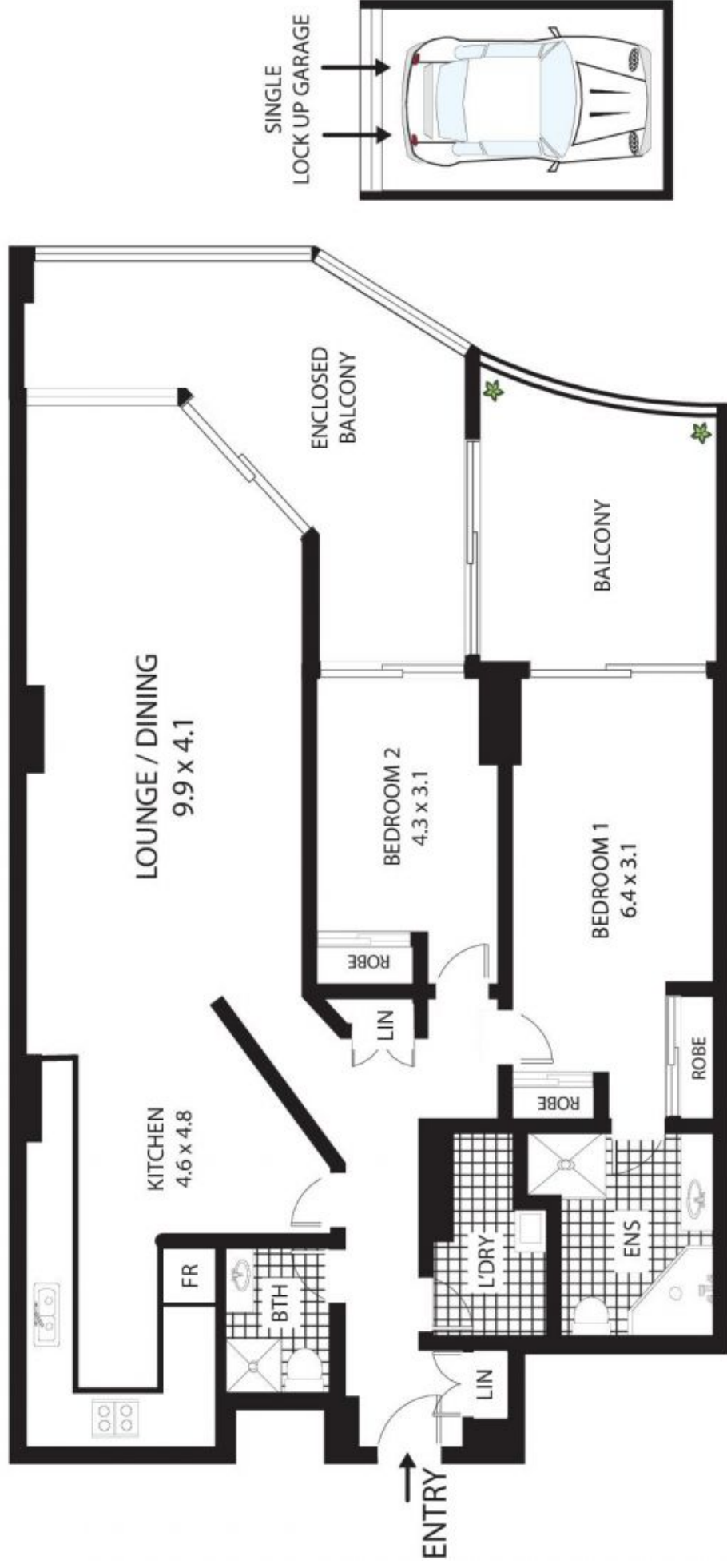

12/222 Sussex St Sydney

All measurements are approximate only. Plan is provided as an indication of layout

