

SYDNEY COVE

PROPERTY



222 Sussex Street Sydney NSW

2 2 1

SOLD BY BRYN FOWLER 0423 663 663

Well-presented 148m² two bedroom apartment now available in highly sought-after and tightly held Astoria Tower. Ideally positioned within an easy walk to Darling Harbour, Cockle Bay restaurants and bars, QVB, and Town Hall. An ideal city residence to enjoy the best Sydney has to offer or solid investment choice with strong tenant demand and assured capital growth.

Type : Apartment

View : <https://www.sydneycoveproperty.com/sale/nsw/sydney-city/sydney/residential/apartment/6214817>

- *Spacious light & airy living areas, two large balconies
- *Two generous double bedrooms with balcony access
- *Two modern bathrooms, master bedroom with ensuite
- *Large gas kitchen, granite bench tops and dishwasher
- *Rare security lock-up garage on title, 24 hour concierge
- *Well-equipped gym, pool, spa, sauna, squash court,



Bryn Fowler
02 8259 3333

[For full version visit the website](https://www.sydneycoveproperty.com)

<https://www.sydneycoveproperty.com>

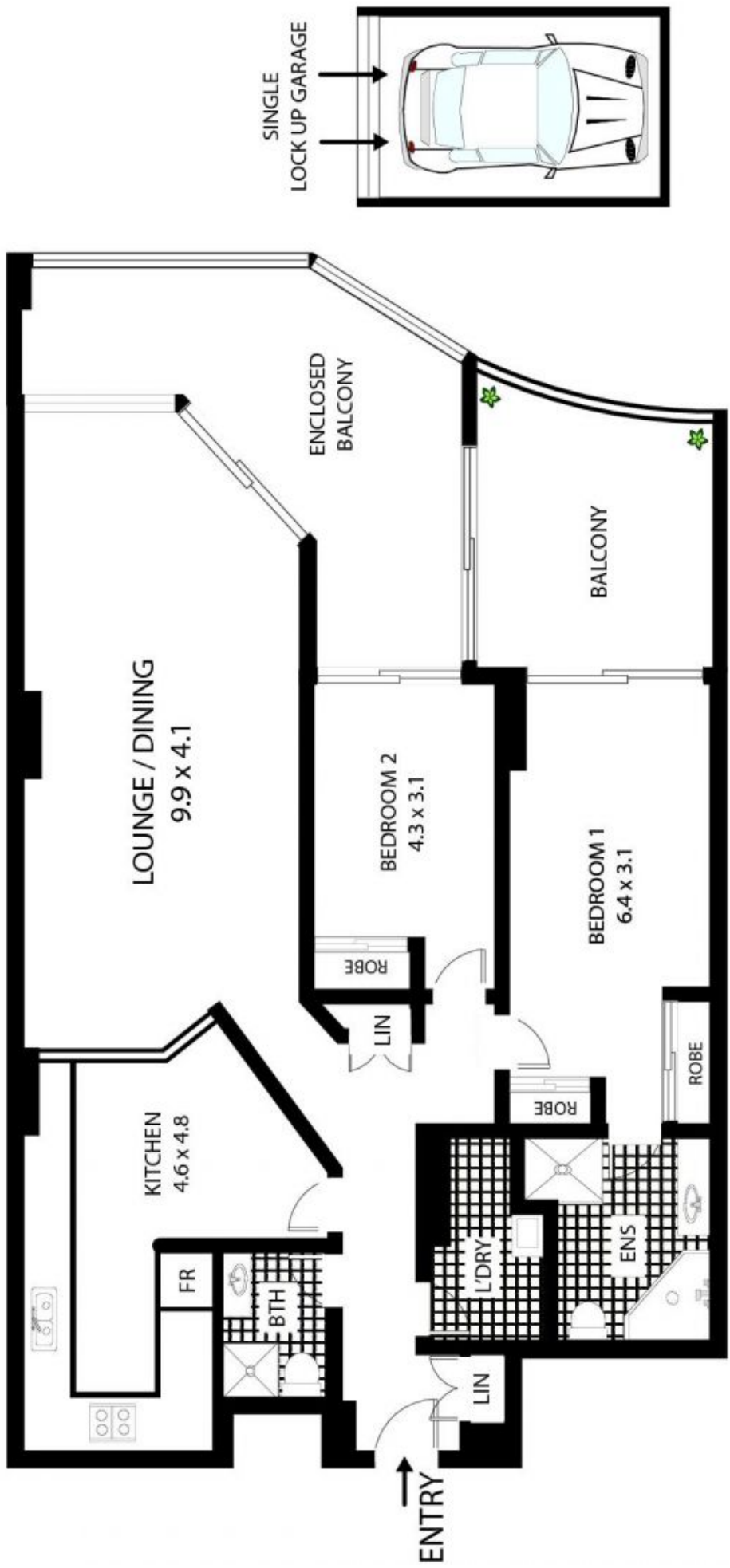

24/222 Sussex St Sydney

All measurements are approximate only. Plan is provided as an indication of layout