

# SYDNEY COVE

PROPERTY



281 Elizabeth Street Sydney NSW

2 2 1

SOLD PRIOR AUCTION - BRYN FOWLER 0423 663 663

Well-presented two bedroom apartment in the coveted and tightly-held Regency Hyde Park, offering a fabulous lifestyle in such an amazing city location. All the city's delights within a short walk from your door, cafes, bars, theatres, museums and restaurants, this apartment is sure to impress. Buses at your door and Museum Train Station across the Street.

**Type** : Apartment

**Price** : \$ 950,000

**View** : <https://www.sydneycoveproperty.com/sale/nsw/sydney-city/sydney/residential/apartment/6214777>

- \* Spacious well-proportioned interiors
- \* Practical floorplan for ease of living
- \* Two double bedrooms with built-ins
- \* Gas kitchen with granite benchtops
- \* Two bathrooms, ensuite with bath
- \* Secure car space right opposite lift



**Bryn Fowler**  
02 8259 3333

[For full version visit the website](https://www.sydneycoveproperty.com)

<https://www.sydneycoveproperty.com>

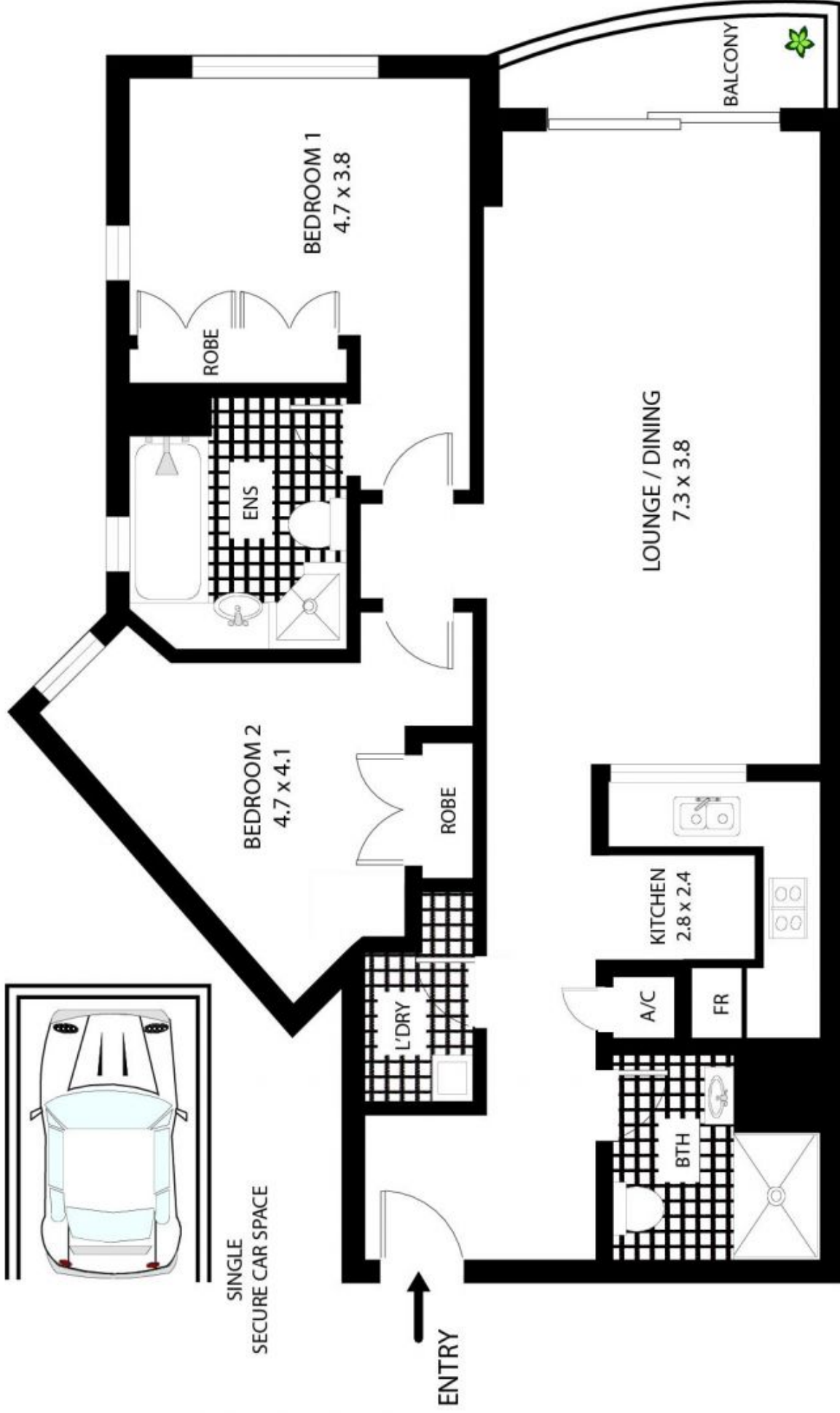

# 805/281 Elizabeth St Sydney

All measurements are approximate only. Plan is provided as an indication of layout