

# SYDNEY COVE

PROPERTY



## 1 Hosking Place Sydney NSW

1 1

With the best floorplan in the building and immaculately presented, this large one bedroom apartment of almost 70m2 would be an ideal city pad. With fantastic city views from its two balconies, light and airy interiors and great layout this apartment is an absolute must to inspect. Nestled between Pitt & Castlereagh Streets and moments to the best of everything Sydney has to offer, The Aston also features an outdoor pool, sundeck, spa, BBQ and gym.

**View :** <https://www.sydneycoveproperty.com/lease/nsw/sydney-city/sydney/residential/apartment/6214314>

### Key Points:

- \* Spacious, light & airy living areas
- \* Two large balconies with city views
- \* Large modern kitchen w/ dishwasher
- \* Large bedroom w/ walk-in wardrobe
- \* Modern ensuite style bathroom

<https://www.sydneycoveproperty.com>

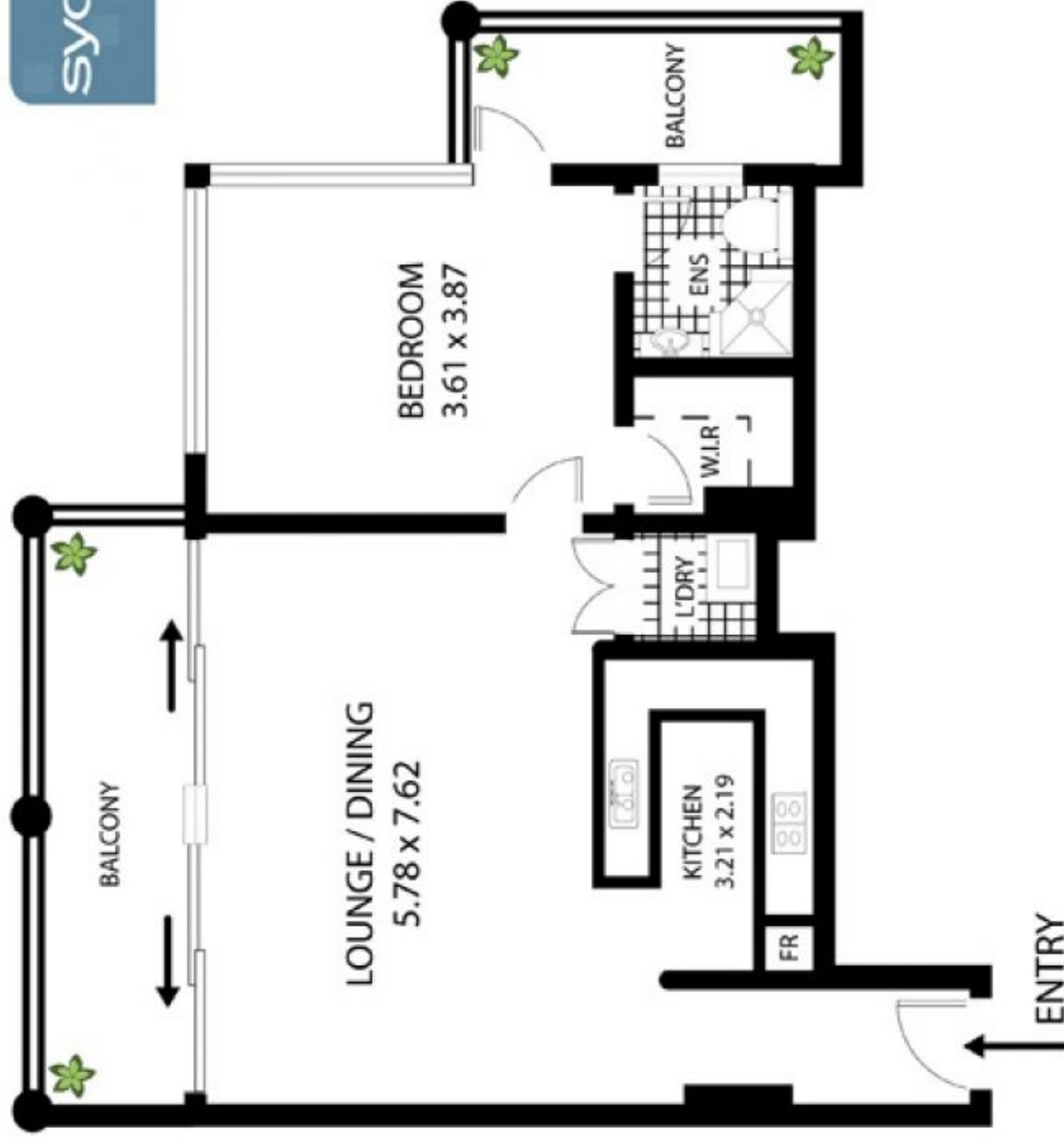

# 1 Hosking Pl Sydney

All measurements are approximate only. Plan is provided as an indication of layout

